

Question or need assistance?

Take a number from the Red Wheel and we will be with you as soon as possible. Please do not disturb the Registration Staff when they are assisting others. Thank you for your patience.

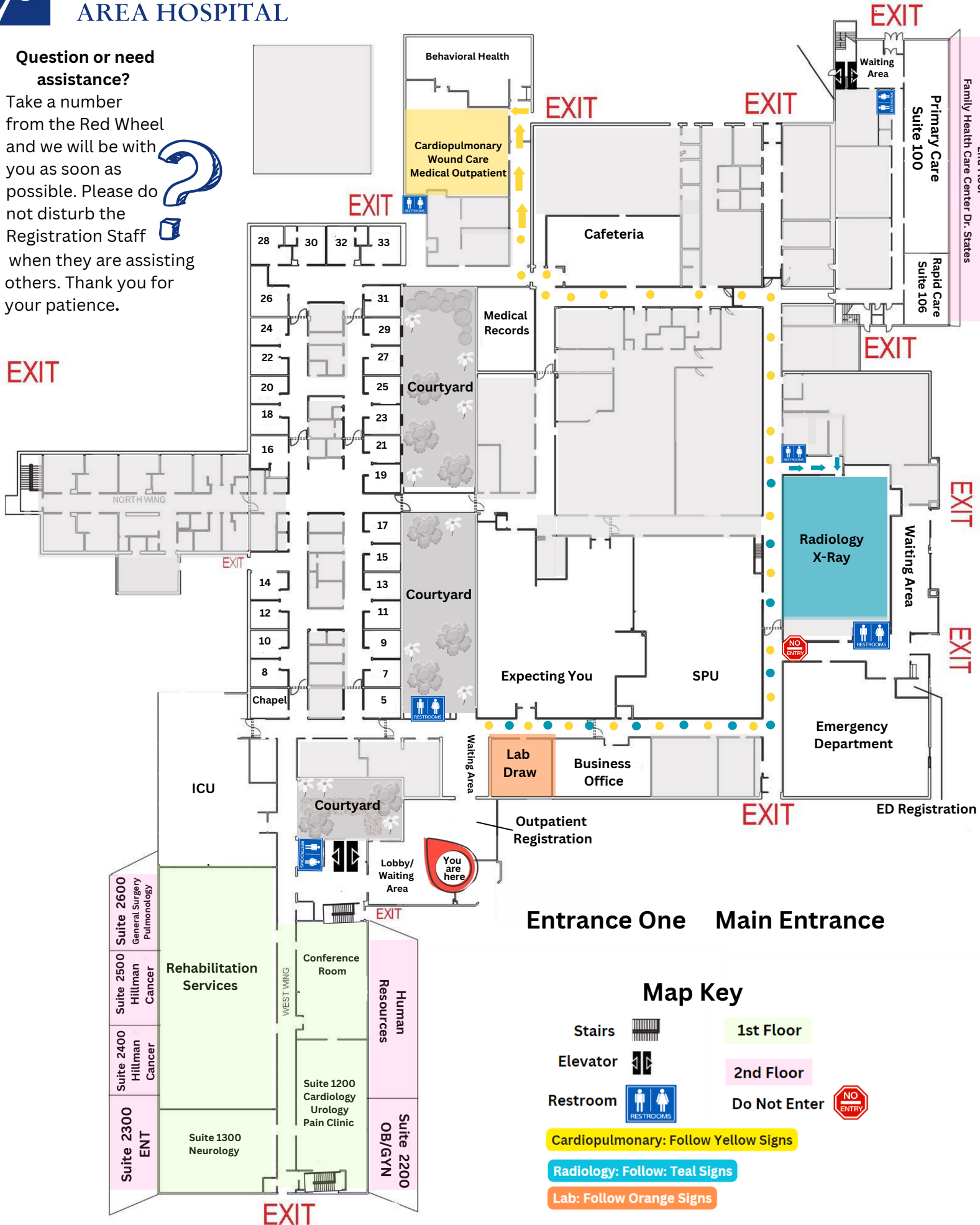

EXIT



Entrance One Main Entrance

Map Key

- Stairs 
- Elevator 
- Restroom 
- 1st Floor 
- 2nd Floor 
- Do Not Enter 
- Cardiacpulmonary: Follow Yellow Signs 
- Radiology: Follow Teal Signs 
- Lab: Follow Orange Signs 